



OAKLEAF
STOVES



The 2026 Collection

TABLE OF CONTENTS



06

ASHWORTH 5



08

BIRCHLEY



10

BIRCHLEY PLUS



12

BIRCHLEY XL



14

FARROW



16

CEDAR 5



18

LANGLEY WIDE



20

HANDALE WIDE



WELCOME HOME

At Oakleaf Stoves, we believe warmth is more than heat it's the heart of a home. From our earliest days as a small family business, we've grown into a trusted name in the stove industry, known for combining traditional craftsmanship with modern innovation.

Each stove reflects our commitment to quality, care and sustainability, ensuring that every Oakleaf stove delivers comfort, style and lasting performance.

Our story is one of steady growth and dedication. What began with just a few handcrafted models has expanded into a full collection of wood burning and multifuel stoves, designed to suit homes of every size and style.

Today, our stoves are enjoyed by households across the country, admired for their efficiency, durability and timeless design.

We remain true to our values of honest workmanship and customer care principles that have guided us since the beginning.

Oakleaf stoves are built for the future as well as today. With Ecodesign certification and advanced clean burn technology, they meet the highest standards for efficiency and low emissions while retaining the charm of a real fire.

From the compact Farrow to the larger Birchley XL, our collection offers something for every home, all with the reassurance of Oakleaf's signature quality.

Choosing an Oakleaf stove means investing in more than a heating appliance it's a choice for dependable warmth, sustainable living and a piece of craftsmanship that will be part of your family life for years to come.

BEAUTY & WARMTH





All Oakleaf stoves are fully Ecodesign compliant, meeting the latest European standards for efficiency and low emissions. This means every model in our collection has been designed with the environment in mind, producing a cleaner burn and reducing the release of harmful particulates into the atmosphere.

By choosing an Ecodesign stove, you're not only investing in reliable warmth for your home but also helping to protect the air we all breathe.

In addition, all of our stoves are DEFRA approved for use in smoke controlled areas, giving you complete peace of mind whether you live in the countryside or in the heart of a town or city.

These models are tested and certified to burn wood cleanly and efficiently, even in areas where strict emissions regulations apply. With Oakleaf, you can enjoy the natural beauty of a real fire without compromise wherever you live.

Ecodesign and DEFRA approval are more than just badges; they represent our commitment to building stoves that are ready for the future. Cleaner burning, lower emissions, and higher efficiency ensure that an Oakleaf stove doesn't just warm your home it does so responsibly.

A modern black wood-burning stove with a fire inside, set in a contemporary living room. To the left, a large potted plant with green, split leaves sits on a light-colored wooden surface. A portion of a light-colored sofa is visible on the far left. The background features light-colored walls and a window with white curtains. The floor is made of light-colored wood. The stove is black with a large glass window showing the fire. It has a chimney pipe on top and a small handle on the right side.

Ashworth 5

Ashworth 5

5kW MULTIFUEL STOVE

The Ashworth is the latest addition to the Oakleaf collection a striking round steel multifuel stove designed to bring both elegance and performance into your home. Its smooth cylindrical shape and flat glass viewing window create a stunning focal point, offering an uninterrupted view of the flames.

Crafted from durable high grade steel, the Ashworth combines contemporary styling with robust engineering. This versatile stove is multifuel ready, giving you the flexibility to burn wood or approved smokeless fuels with ease.



SPECIFICATIONS			
COLLAR	5" / 127MM		
FUEL TYPE	MULTIFUEL		
OUTPUT	5KW		
EFFICIENCY	82.2%		
HEIGHT	921MM		
WIDTH	500MM		
DEPTH	446MM		
WEIGHT	93.7KG		
WARRANTY	5 YEARS		
ENERGY RATING	A+		
TEST POINT FITTED	YES		
DISTANCE TO MATERIALS		ABOVE	SIDE
COMBUSTIBLES		750MM	50MM
			BACK
			50MM

Approved for use on a 12mm decorative hearth.

*A minimum hearth depth of 300 mm is required in front of the stove.

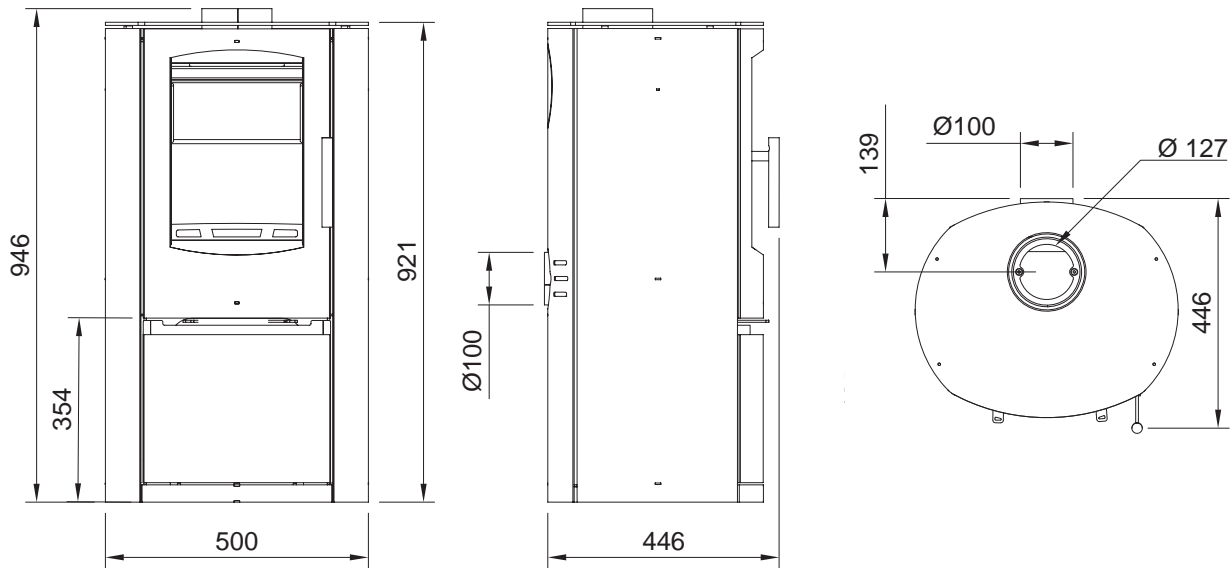

A modern wood-burning stove with a fire, a fireplace with patterned wallpaper, and a set of fireplace tools. The stove is dark grey with a large glass window showing a bright fire. The fireplace has dark wallpaper with a light-colored geometric pattern. To the left, a set of three fireplace tools with silver-colored handles stands on a dark surface. The floor is made of light-colored wood.

Birchley

Birchley

5kW WOOD BURNING* STOVE

The Birchley 5kW is a compact yet powerful wood burning stove, designed to bring classic warmth and character into any home. With its timeless styling and robust cast iron door, the Birchley perfectly balances traditional charm with modern efficiency.

Its large glass window ensures a clear, radiant view of the flames, while the clean burn system maximises efficiency and reduces emissions.

***Optional Multifuel Kit Available**

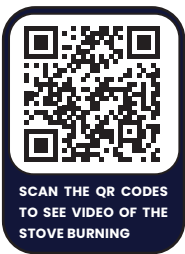

SPECIFICATIONS	
COLLAR	5" / 127MM
FUEL TYPE	WOOD BURNING
OUTPUT	5KW
EFFICIENCY	84.4%
HEIGHT	500MM
WIDTH	420MM
DEPTH	335MM
WEIGHT	65KG
WARRANTY	5 YEARS
ENERGY RATING	A
TEST POINT FITTED	YES

DISTANCE TO MATERIALS	ABOVE	SIDE	BACK
COMBUSTIBLES	450MM	500MM	275MM
NON COMBUSTIBLES	350MM	75MM	75MM

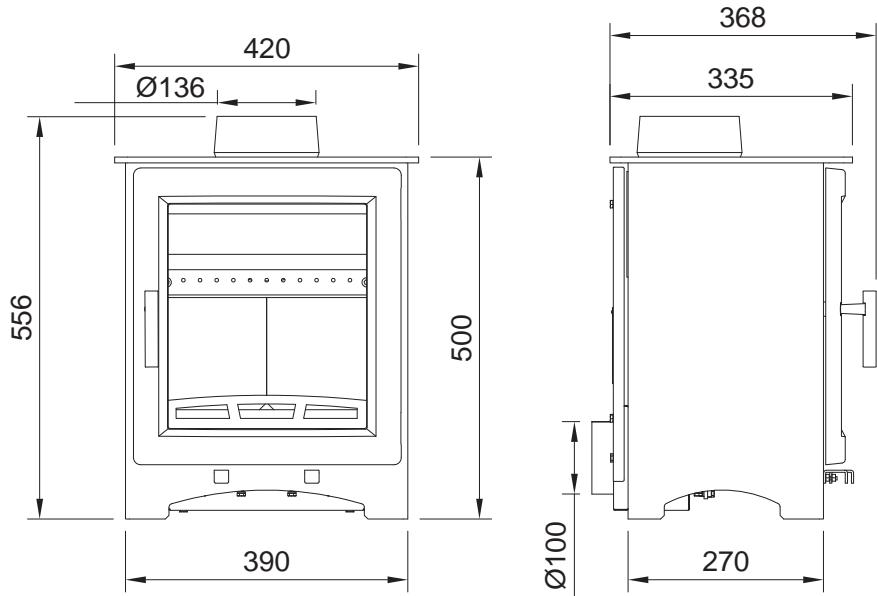

* A minimum hearth depth of 300 mm is required in front of the stove.

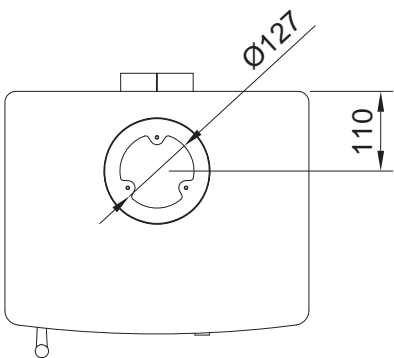

A black wood-burning stove is the central focus, with a bright fire burning inside. The stove has a tall chimney pipe on top and a small handle on the left side. The background consists of a modern interior with a white wall and a dark floor. A dark blue banner with white text is overlaid on the left side of the image.

Birchley Plus

Birchley Plus

5kW MULTIFUEL STOVE

The Birchley Plus takes everything you love about the original Birchley and makes it bigger, bolder and even more versatile. This model delivers increased heat output while retaining the classic styling and robust build quality of the range. The Plus comes as a dedicated multifuel stove, complete with a built in riddling system for easy ash management and cleaner burning.

With its generous viewing window, you'll enjoy a perfect flame picture alongside the confidence of Oakleaf's Ecodesign performance.

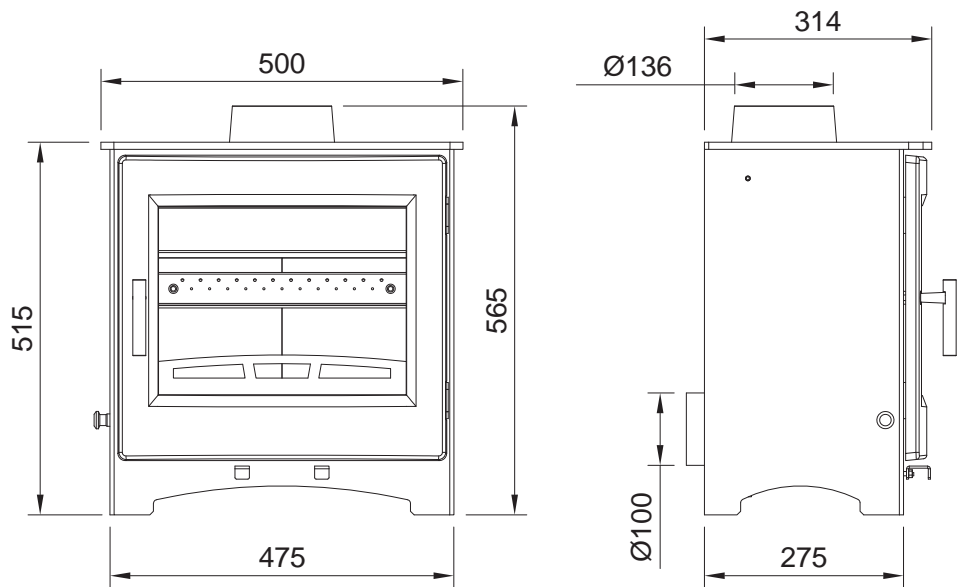

SPECIFICATIONS	
COLLAR	5" / 127MM
FUEL TYPE	MULTIFUEL
OUTPUT	5KW
EFFICIENCY	81.5%
HEIGHT	515MM
WIDTH	500MM
DEPTH	314MM
WEIGHT	83KG
WARRANTY	5 YEARS
ENERGY RATING	A
TEST POINT FITTED	YES

DISTANCE TO MATERIALS	ABOVE	SIDE	BACK
COMBUSTIBLES	450MM	400MM	400MM
NON COMBUSTIBLES	400MM	75MM	75MM

* A minimum hearth depth of 300 mm is required in front of the stove.

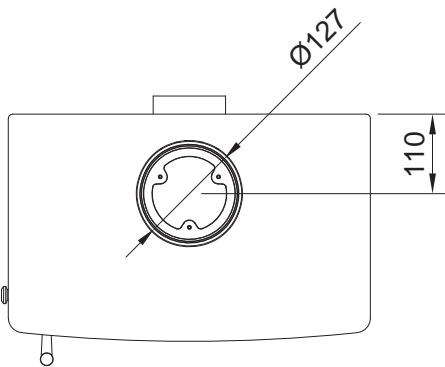

A black wood-burning stove with a fire inside, next to a fireplace tool set. The stove is a boxy, black metal unit with a large rectangular glass window in the center showing a bright fire of logs and flames. A black chimney pipe extends from the top. To the left, a set of three fireplace tools (poker, tongs, and shovel) with ornate silver-colored handles stands against a dark blue wall. The stove sits on a dark surface, and the background is a light grey wall.

Birchley XL

Birchley XL

5kW WOOD BURNING* STOVE

For those who want the very best in size, presence and performance, the Birchley XL is the ultimate expression of the Birchley range. This stove is designed to heat expansive living areas while making a stunning statement in any home.

With its commanding proportions and wide glass viewing window, the XL showcases a truly impressive flame display.

***Optional Multifuel Kit Available**

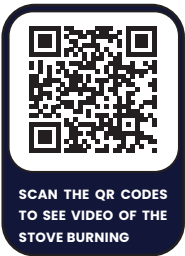

SPECIFICATIONS	
COLLAR	5" / 127MM
FUEL TYPE	WOOD BURNING
OUTPUT	5KW
EFFICIENCY	83.9%
HEIGHT	560MM
WIDTH	550MM
DEPTH	335MM
WEIGHT	87KG
WARRANTY	5 YEARS
ENERGY RATING	A
TEST POINT FITTED	YES

DISTANCE TO MATERIALS	ABOVE	SIDE	BACK
COMBUSTIBLES	450MM	350MM	350MM
NON COMBUSTIBLES	350MM	75MM	75MM

* A minimum hearth depth of 300 mm is required in front of the stove.

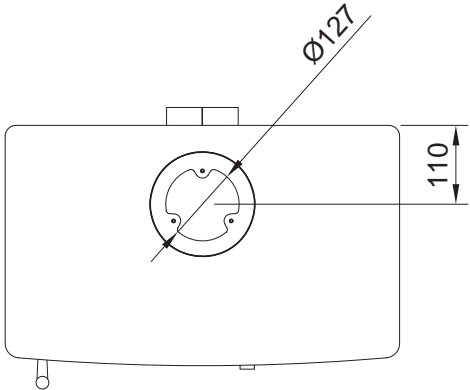
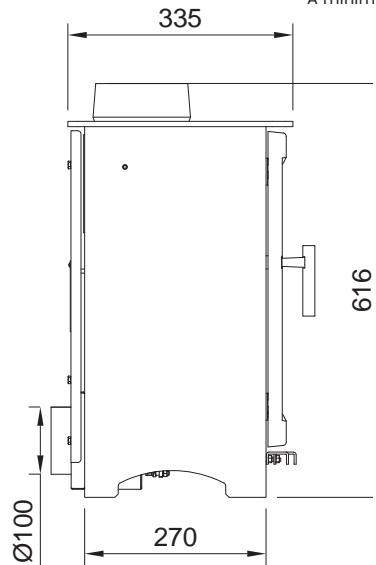
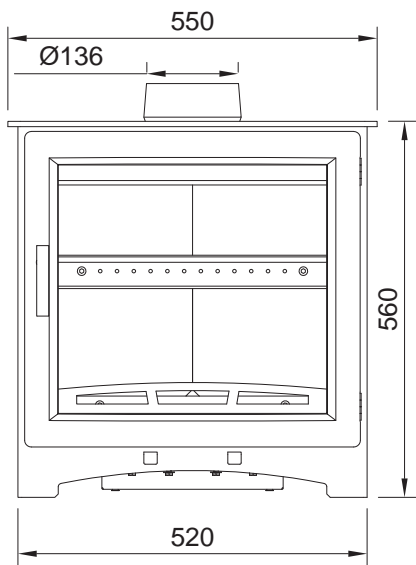



Farrow

Farrow

5kW MULTIFUEL STOVE

The Farrow 5kW is a stylish, contemporary stove that delivers impressive performance in a compact package. With its clean lines, modern steel body and large viewing window, the Farrow brings a sleek, minimalist look to any living space while offering the comforting warmth of a real fire.

The Farrow provides a steady 5kW heat output perfect for small to medium sized rooms. Its advanced clean burn technology ensures excellent efficiency, reduced emissions, and a crystal clear flame picture.

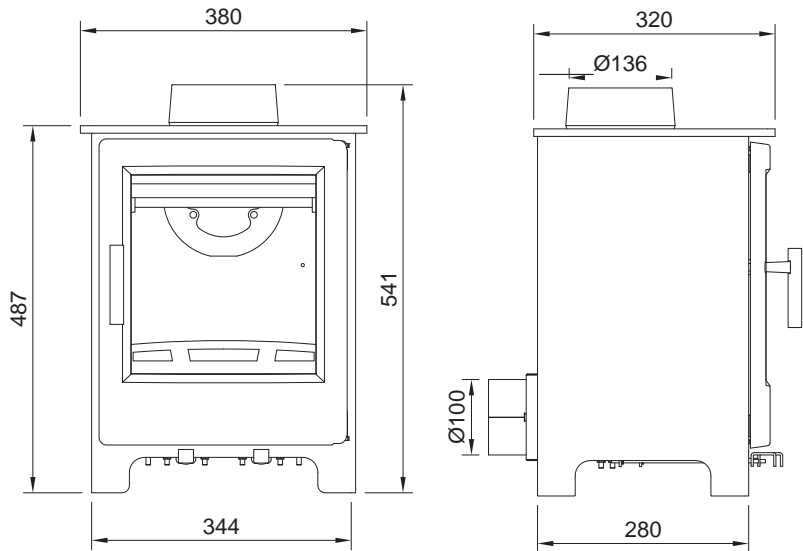

SPECIFICATIONS	
COLLAR	5" / 127MM
FUEL TYPE	MULTIFUEL
OUTPUT	5KW
EFFICIENCY	86.5%
HEIGHT	487MM
WIDTH	380MM
DEPTH	320MM
WEIGHT	64KG
WARRANTY	5 YEARS
ENERGY RATING	A
TEST POINT FITTED	YES

DISTANCE TO MATERIALS	ABOVE	SIDE	BACK
COMBUSTIBLES	450MM	500MM	600MM
NON COMBUSTIBLES	300MM	75MM	75MM

* A minimum hearth depth of 300 mm is required in front of the stove.

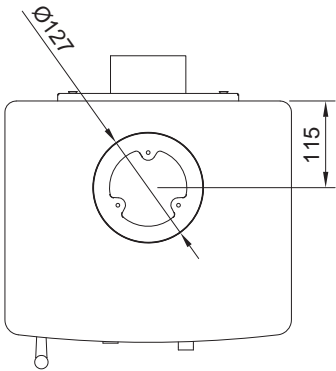



Cedar 5

Cedar 5

5kW MULTIFUEL STOVE

The Cedar 5 is one of Oakleaf's bestselling stoves and for good reason. Compact yet powerful, this 5kW model is designed to deliver outstanding performance, timeless style and the dependable quality that has made it a customer favourite.

Perfectly suited to a wide range of interiors, the Cedar 5 combines traditional stove charm with modern efficiency. Its cast iron construction retains and releases heat for longer while the large glass viewing window provides a clear, captivating flame picture.



SPECIFICATIONS	
COLLAR	5" / 127MM
FUEL TYPE	MULTIFUEL
OUTPUT	5KW
EFFICIENCY	80.7%
HEIGHT	525MM
WIDTH	445MM
DEPTH	293MM
WEIGHT	75KG
WARRANTY	10 YEARS
ENERGY RATING	A
TEST POINT FITTED	YES

DISTANCE TO MATERIALS	ABOVE	SIDE	BACK
COMBUSTIBLES	450MM	600MM	600MM
NON COMBUSTIBLES	50MM	50MM	50MM

* A minimum hearth depth of 300 mm is required in front of the stove.

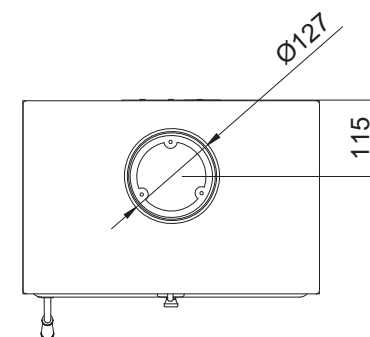
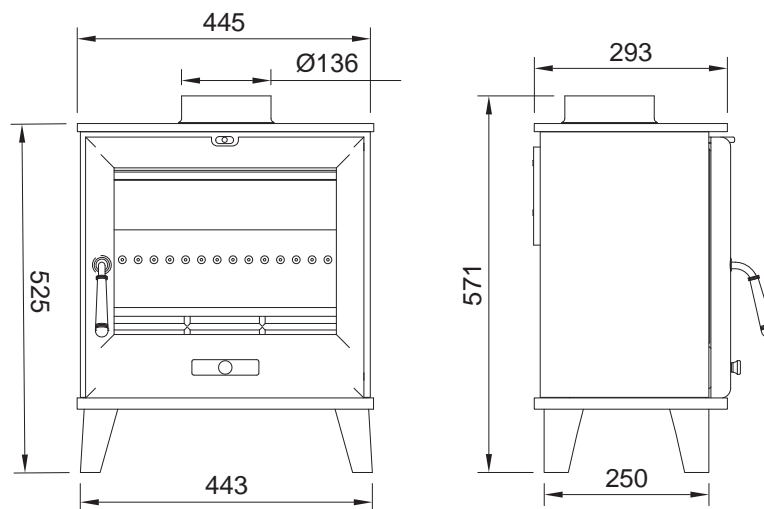

A black wood-burning stove with a large glass window showing a fire. It has a black chimney pipe on top and a silver handle on the right side. The stove is set against a wall with a herringbone pattern of dark wood. To the left of the stove is a teal wall and a window with a white frame. In the foreground, there is a wicker basket on a black metal stand.

Langley Wide

Langley Wide

5kW MULTIFUEL STOVE

The Langley Wide is a striking stove that combines powerful performance with contemporary style. Its wide glass window offers a generous flame view, creating a warm and inviting focal point in any home.

Built as a multifuel model, the Langley gives you the flexibility to burn wood or approved smokeless fuels, ensuring reliable heating whatever your preference. strong steel construction, advanced clean burn technology.



SPECIFICATIONS	
COLLAR	5" / 127MM
FUEL TYPE	MULTI FUEL
OUTPUT	5KW
EFFICIENCY	84.9%
HEIGHT	550MM
WIDTH	470MM
DEPTH	305MM
WEIGHT	68KG
WARRANTY	LIFETIME (On Stove Body)
ENERGY RATING	A
TEST POINT FITTED	YES

DISTANCE TO MATERIALS	ABOVE	SIDE	BACK
COMBUSTIBLES	600MM	500MM	500MM
NON COMBUSTIBLES	100MM	100MM	100MM

* A minimum hearth depth of 300 mm is required in front of the stove.

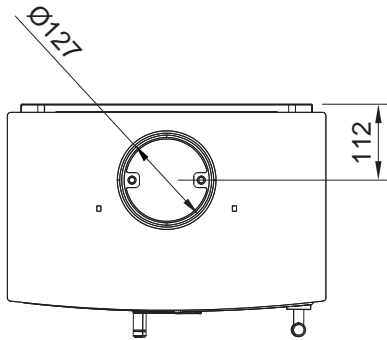
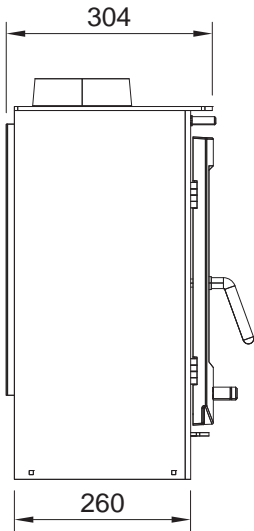
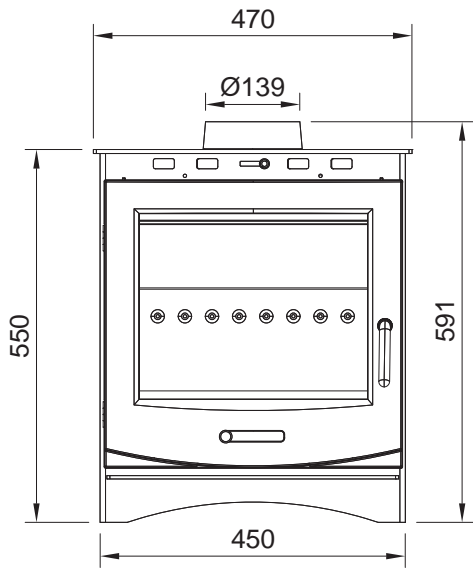



Handale Wide

Handale Wide

5kW MULTIFUEL STOVE

The Handale Wide is designed to make a statement. With its commanding presence and panoramic viewing glass, it showcases the beauty of a real fire while offering impressive heating performance.

As a multifuel stove, the Handale provides complete flexibility, allowing you to choose between wood or approved smokeless fuels. Engineered for durability and efficiency.



SPECIFICATIONS	
COLLAR	5" / 127MM
FUEL TYPE	MULTI FUEL
OUTPUT	5KW
EFFICIENCY	84.9%
HEIGHT	550MM
WIDTH	470MM
DEPTH	306MM
WEIGHT	64KG
WARRANTY	LIFETIME (On Stove Body)
ENERGY RATING	A
TEST POINT FITTED	YES

DISTANCE TO MATERIALS	ABOVE	SIDE	BACK
COMBUSTIBLES	600MM	500MM	500MM
NON COMBUSTIBLES	100MM	100MM	100MM

* A minimum hearth depth of 300 mm is required in front of the stove.

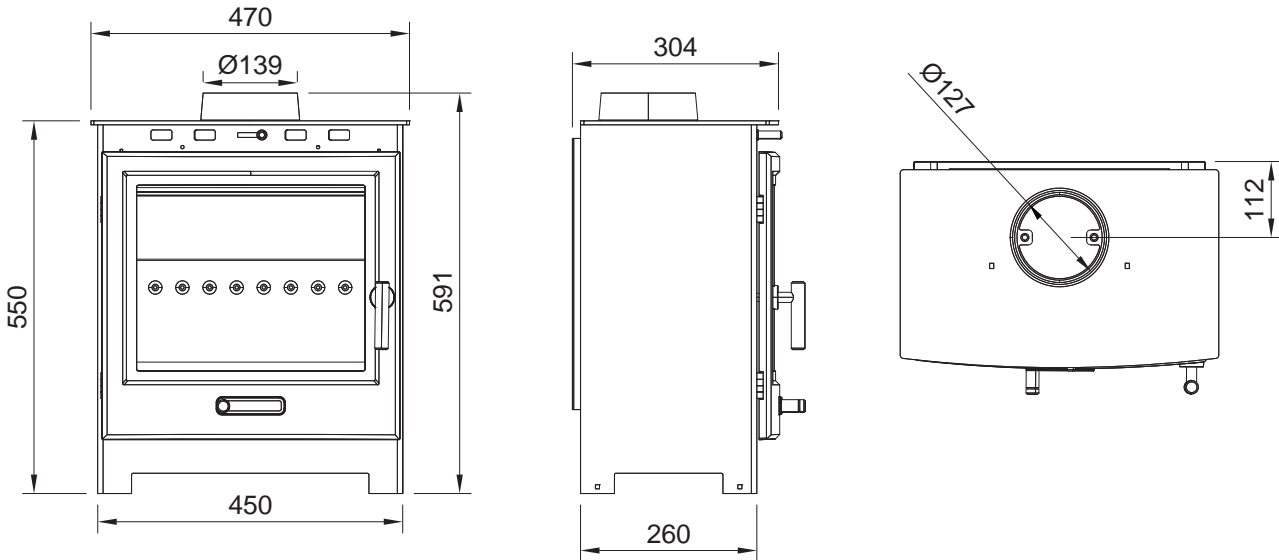



STOVE SIDE ACCESSORIES

Oakleaf Stoves offers a carefully selected range of stove accessories designed to complement and enhance your stove. From essential tools to stylish finishing touches, each accessory is chosen for its quality, durability and practicality ensuring your stove not only looks its best but performs at its peak.

Our collection includes companion sets with neatly crafted brushes, pokers and tongs for easy fire management, as well as log baskets and storage solutions to keep fuel tidy and close to hand. We also supply heat-resistant gloves, ash carriers and bellows giving you complete confidence in safety while enjoying the warmth of your stove.

For those who want to make their Oakleaf stove even more versatile, we offer a choice of optional extras and upgrades, such as multifuel kits, additional mantels and stove fans that help distribute heat evenly throughout your living space.

Every Oakleaf accessory is built to the same high standards as our stoves they are practical, reliable, and made to last. Whether you're tending the fire, storing your logs or looking for that extra detail to complete your stove setup, our accessory range provides everything you need to make the most of your Oakleaf stove experience.



COMPANION SETS

TRIANGLE COMPANION SET
 26" 4 PIECE CREST COMPANION SET
 MATT BLACK WALL HANDING 4PC FIRE TOOL SET
 25" BLACK & PEWTER 5 PIECE COMPANION SET
 17" BLACK 5 PIECE COMPANION SET
 21" PEWTER 5 PIECE FLEUR DE LYS COMPANION SET
 21" BLACK 5 PIECE FLEUR DE LYS COMPANION SET
 24" BLACK 5 PIECE CUBE TOP COMPANION SET
 25" OVAL HANDLE 5 PIECE COMPANION SET
 25" BALL TOP 5 PIECE COMPANION SET BLACK

ING026
 FIRE86
 FIRE214
 FIRE36
 FIRE89
 FIRE116
 FIRE113
 FIRE112
 FIRE28
 FIRE79

STOVE TOOLS

5.5" BLACK SHOVEL
 9" BLACK SHOVEL WITH WOODEN HANDLE
 18" BLACK LOOP HANDLE SHOVEL
 BLACK SHOVEL & BRUSH SET
 BLACK BANNISTER DUSTPAN AND BRUSH SET
 SINGLE LOOP HANDLE FLAT SCRAPER BLACK
 SINGLE LOOP HANDLE CURVED SCRAPER BLACK
 18" BLACK LOOP HANDLE POKER
 18" BLACK LOOP HANDLE TRADITIONAL POKER
 19" BLACKER POKER
 18" ALL BLACK SINGLE LOOP BRUSH
 CAST IRON SCISSOR TONGS MATT BLACK
 12" BLACK SINGLE SCISSOR TONGS
 18" BLACK LOOP HANDLE TONGS

FIRE80
 FIRE111
 FIRE136
 FIRE82
 FIRE212
 FIRE75
 FIRE74
 FIRE138
 FIRE135
 FIRE129
 FIRE134
 FIRE217
 FIRE130
 FIRE137

LOG BASKETS/STORES

DARK WICKER BASKET WITH CHROME HANDLES
 LOG CART & COMPANION SET
 GREY WILLOW BASKET LARGE
 GREY WILLOW BASKET LARGE
 SMALL HEAVY DUTY CAST IRON LOG BASKET
 LARGE HEAVY DUTY CAST IRON LOG BASKET
 FOLDING LOG RACK WITH HANDLES BLACK
 STAINLESS STEEL LOG RACK

FIRE200
 LOG09
 WILLOWL
 WILLOWS
 LOG01
 LOG07
 LOG03
 LOG11

BUCKETS & HODS

PREMIUM BLACK WATERLOO BUCKET/PEWTER BAND
 CREAM WATERLOO BUCKET
 SET OF 2 NESTED BLACK COAL BUCKETS
 PREMIUM SET OF 2 BUCKETS LOGS, KINDLING
 BLACK WATERLOO BUCKET & SHOVEL SET
 BLACK METAL ASH BUCKET WITH LID
 CREAM COAL HOD
 BLACK COAL HOD
 BLACK ELLIPSE HOD

ING08
 ING035
 COAL06
 ING37S2
 FIRE81
 FIRE176
 ING036
 COAL03
 COAL13

GENERAL ACCESSORIES

CREAM MATCH HOLDER WITH LONG MATCHES
 PREMIUM METAL MATCHES HOLDER
 PAIR OF ALL BLACK FIREGLOVES
 DARK BROWN WOODEN BELLOWS
 2 BLADE STOVE FAN BLACK
 SILVER ASH PAN HANDLE
 16" SILVER ASH PAN

FIRE144C
 ING011
 FGLOV
 FIRE154
 FIRE195
 FIRE173
 FIRE172

Get In Touch

